



SPECIFICATIONS

Product Description: **8" (20.3 cm) AXIAL EXPLOSION-PROOF PLASTIC BLOWER**
 Part Number: **9538, 9538-15, 9538-25, 9538-50**
 Style: **WITH OR WITHOUT CANISTER**

GENERAL DESCRIPTION:

High output from a compact axial blower, designed for easy use and storage without sacrificing airflow. Available as blower only or complete unit with 15' (4.57 m), 25' (7.62 m) or 50' (15.2 m) of statically conductive ducting and storage canister. Canister attaches to the intake or output of the blower for suction or ventilation. It is designed for explosion proof environments. Certified to CSA Standard C22.2 No. 113.

CONSTRUCTION:

- New compact canister in 9538-15 and 9538-25 models is the lightest and smallest in the industry!
- Polyethylene housing and canister assembly
- Lightweight, corrosion-, UV- and chemical-resistant
- Super quiet, "safety orange"
- Bottom enclosure to protect electrical components
- Carry handle molded into blower and canister housing
- Steel powder coated grill
- *NOTE: EX blowers require an explosion-proof socket (PN 9503-03)*

MOTOR:

HP: 1/3
 Certifications: UL Recognized, CSA Certified
 Voltage/Hz: 115V, 60 Hz, Single Phase
 Max RPM: 3250
 Current Draw: 2.2A
 Cord: 25' (7.62 m) SJOOW 18/3 AWG 300V, medium duty
 Plug: NEMA 115V, 20 amp, "ECP" type

FAN:

- Polypropylene six blade fan, aluminum hub

DUCTING: (included on 9538-15, 9538-25 and 9538-50 models)

- Black single-ply lightweight vinyl/polyester coated with neoprene 250° F (121.1° C) temp. resistant
- Non-collapsible retractable design, Class 1 hard drawn spring steel wire helix
- *WARNING: When using statically conductive ducting, the integrated grounding wire must be properly grounded to the blower chassis OR linked to any additional grounding wire or duct used (as shown). Refer to User Manual for detailed instructions.*

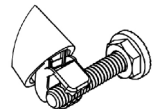

HAZARDOUS LOCATION RATINGS:

Class: I	Class: II
Divisions: 1 & 2	Division: 1 & 2
Groups: C & D	Groups: F & G

BLOWER DIMENSIONS: (9538 - blower only)

Blower P/N	Length	Width	Height	Weight
9538	13 1/4" (33.6 cm)	12" (30.4 cm)	13 3/4" (34.9 cm)	17 lbs. (7.7 kg)
9538-15	26" (66.0 cm)	13 1/2" (34.2 cm)	14 1/2" (36.8 cm)	25 lbs. (11.3 kg)
9538-25	26" (66.0 cm)	13 1/2" (34.2 cm)	14 1/2" (36.8 cm)	30 lbs. (13.6 kg)
9538-50	32" (81.3 cm)	13 1/2" (34.2 cm)	14 1/2" (36.8 cm)	40 lbs. (18.1 kg)

FLOW RATES: (CFM calculated using 15' (4.57 m) of 8" (20.3 cm) ducting)

Free Air	One 90° Bend	Two 90° Bends
900 CFM (1529.1 m ³ /hr)	650 CFM (1104.35 m ³ /hr)	625 CFM (1061.8 m ³ /hr)



9538 (Blower only), 9538-15, 9538-25



9538-50